

Volkswagen Corrado 1990 - 1994

Body

Hoods Lids (Page GR-55)

Gas-filled strut

- [assembly](#)
- [discarding](#)

Hood

- [assembly](#)
- [bowden cable, assembly](#)
- [hinge, assembly](#)
- [gap, adjusting](#)
- [radiator support](#)
- [rubber stop, adjusting](#)
- [sound deadener, installing](#)
- [striker, adjusting](#)
- [support, replacing](#)

Rear lid

- [adjusting](#)
- [assembly](#)
- [lock, assembly](#)
- [lock cylinder, replacing](#)
- [lid release, replacing](#)
- [lock, repairing](#)
- [rubber stop, adjusting](#)
- [spring pin, removing](#)

Volkswagen Corrado 1990 - 1994
Body
Hoods, Lids (Page 55-2)

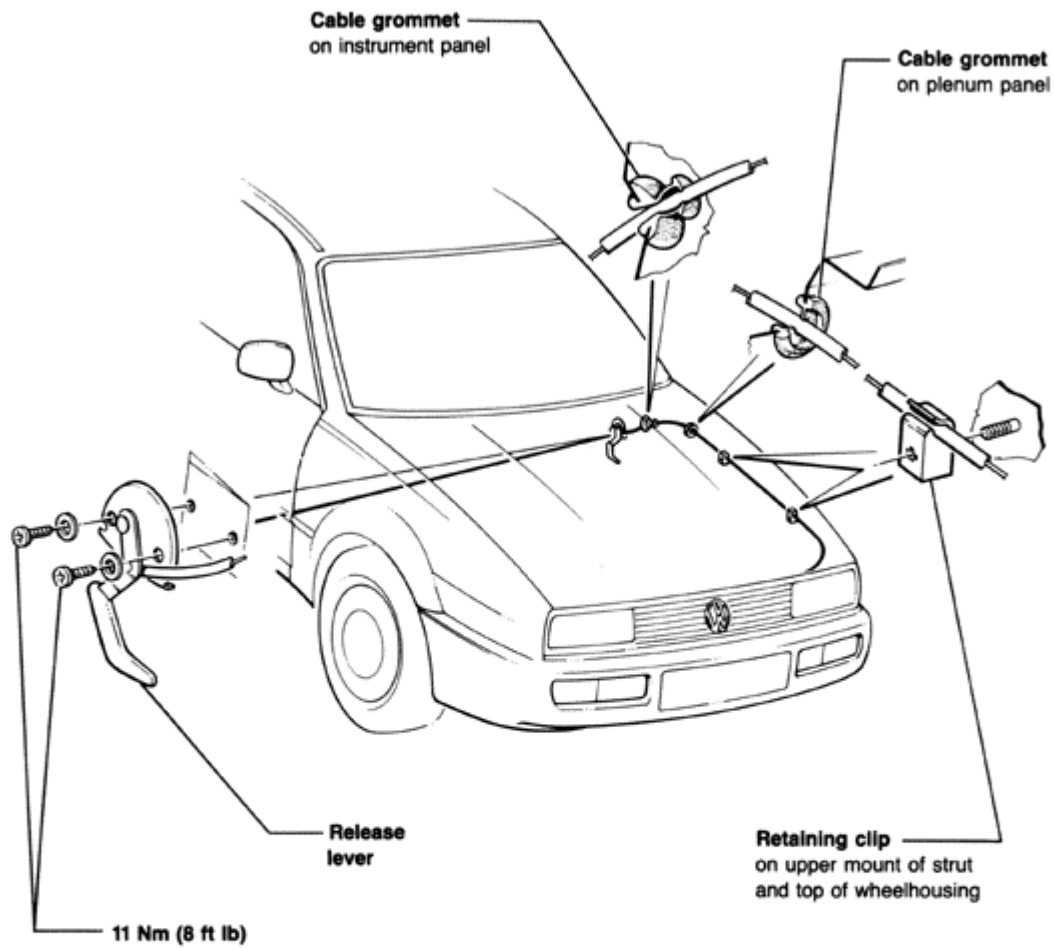

Volkswagen Corrado 1990 - 1994
Body
Hoods, Lids (Page 55-3)

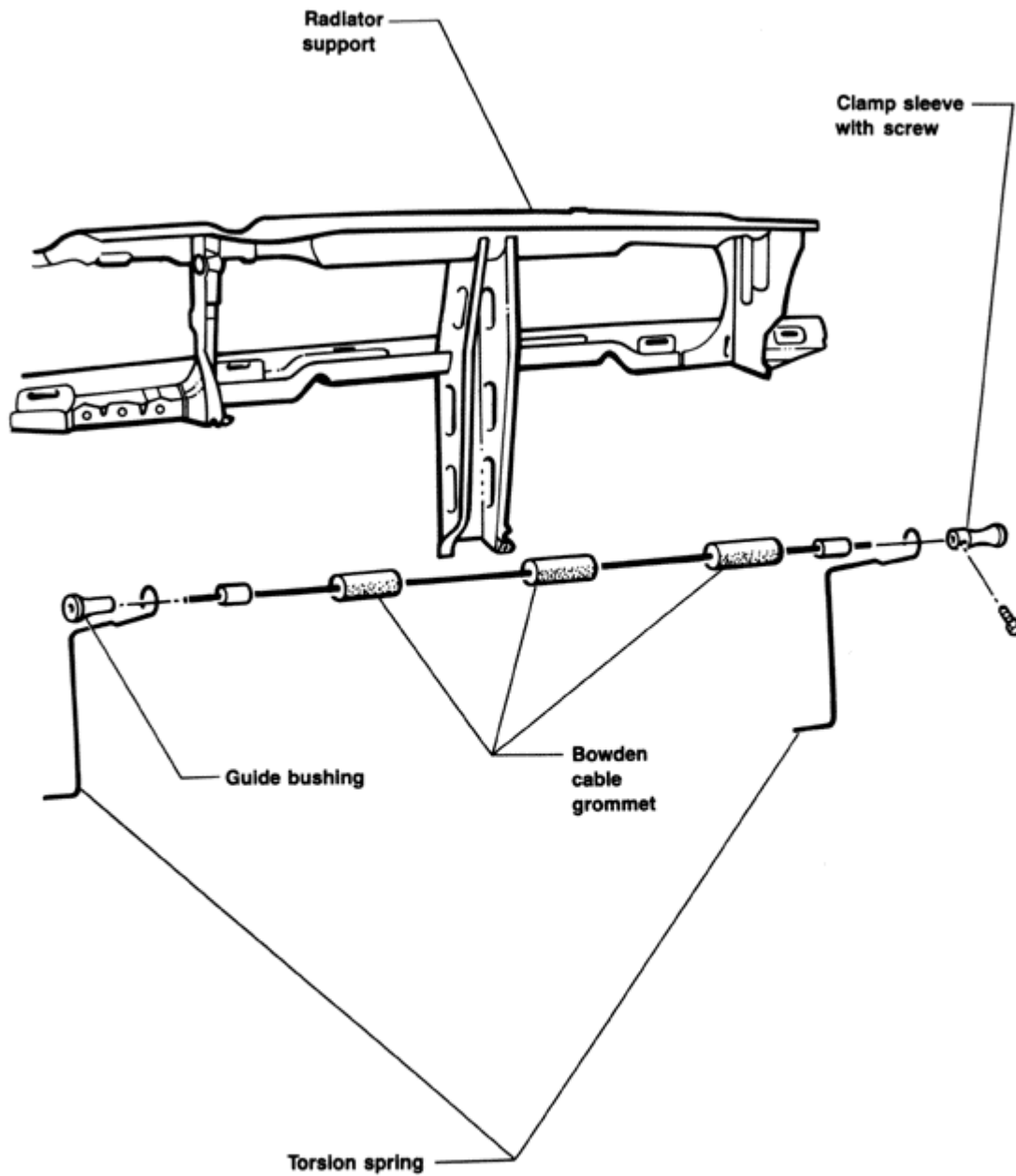

Volkswagen Corrado 1990 - 1994
Body
Hoods, Lids (Page 55-4)

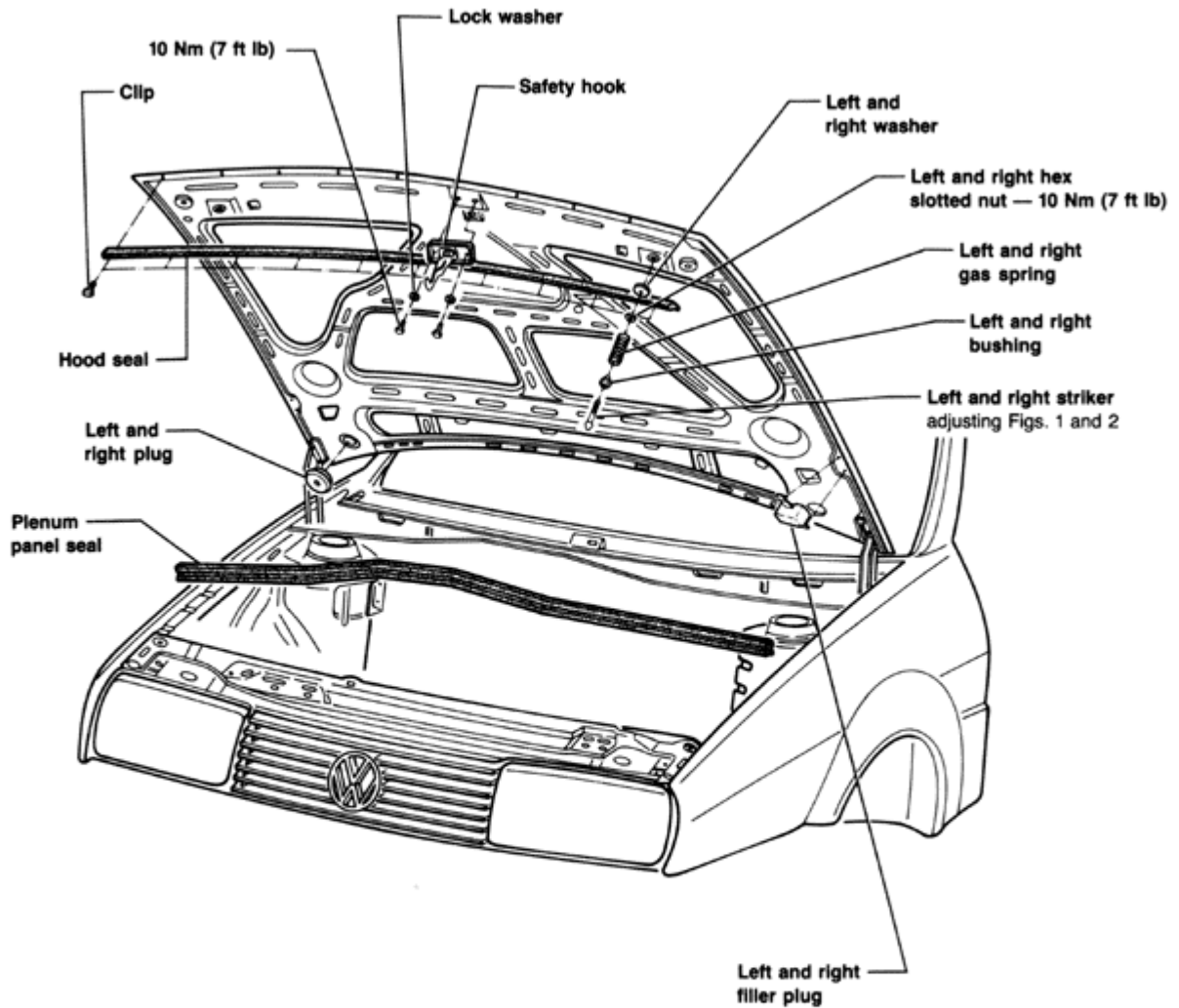

Volkswagen Corrado 1990 - 1994
Body
Hoods, Lids (Page 55-5)

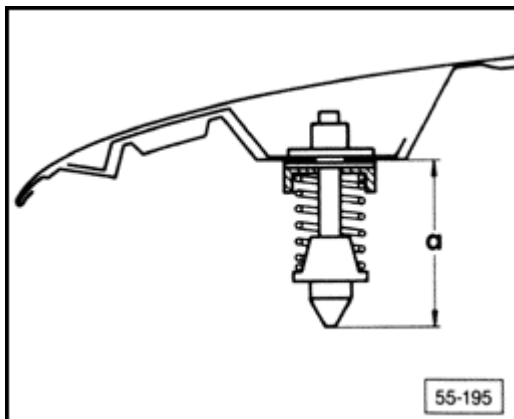

A

Fig. 1 Striker, adjusting

- adjust both strikers to dimension $a = 57 \text{ mm (2.1 in.)}$
- rubber stops must be screwed completely in

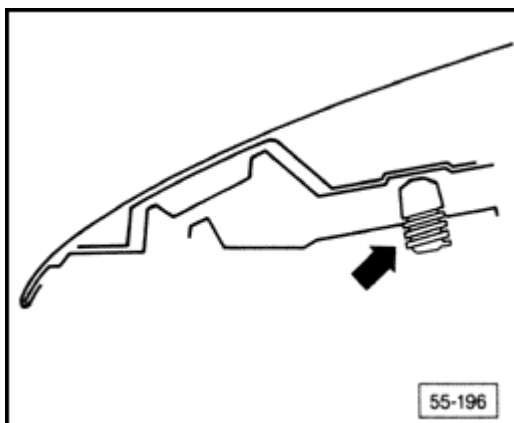

A

Fig. 2 Rubber stop, adjusting

- fully screw in both rubber stops
- adjust hood flush with fenders by turning out both rubber stops (**arrow**)

CAUTION!

Part numbers are for reference only. Always check with your Parts Department for latest information.

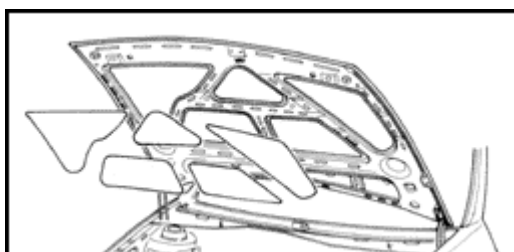



Hood sound deadener, Installing

- before bonding sound deadener to hood, clean inner panel with cleaning solution, Part No. **D 009 400 01**

Volkswagen Corrado 1990 - 1994
Body
Hoods, Lids (Page 55-6)

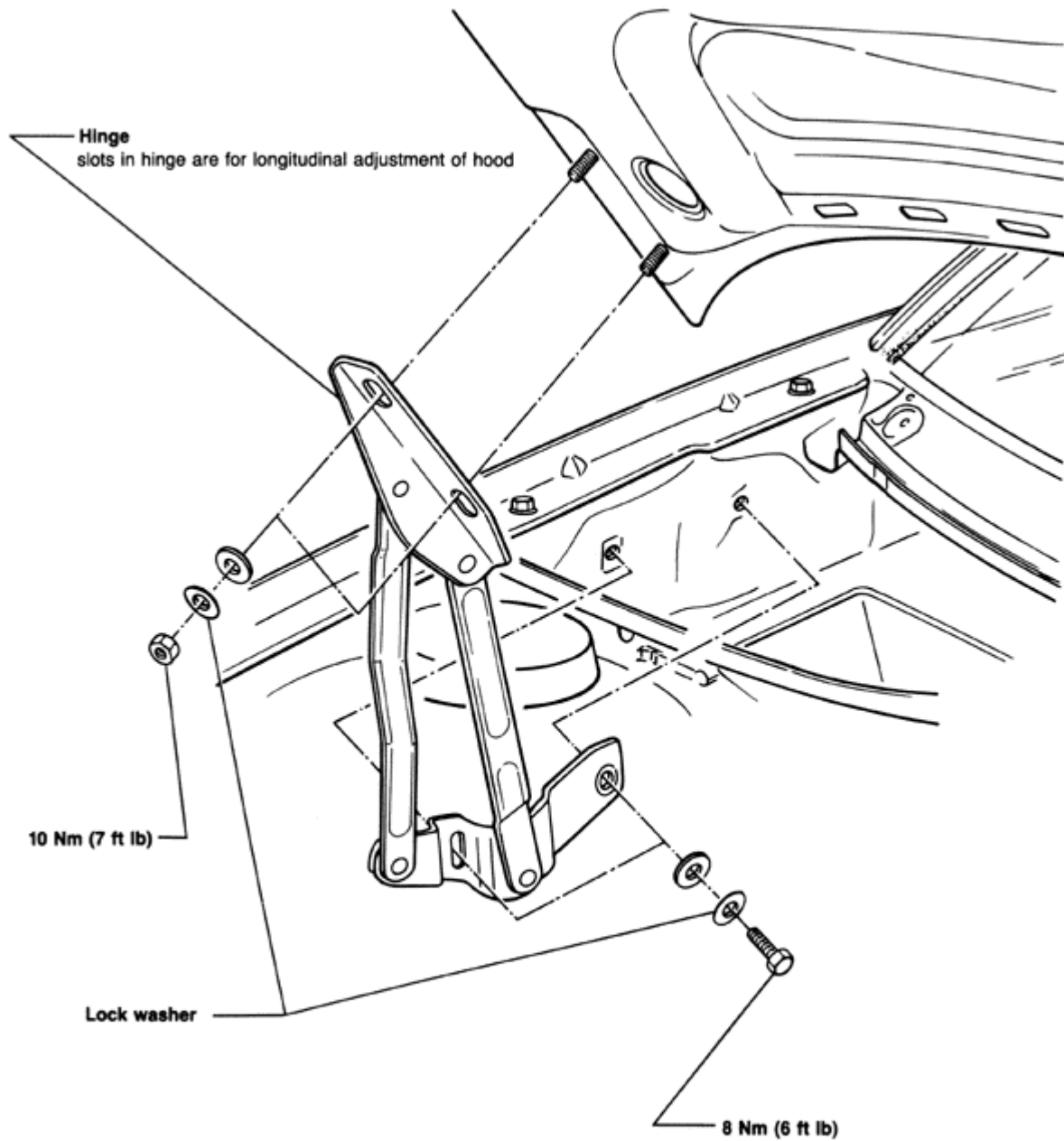

Volkswagen Corrado 1990 - 1994

Body

Hoods, Lids (Page 55-7)

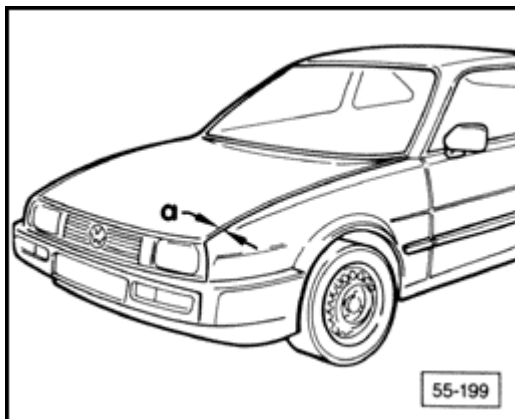

A

Hood gap, adjusting

- adjust gap by moving fender after loosening fender screws
 - a = 5.0 mm (13/64 in.)

Volkswagen Corrado 1990 - 1994
Body
Hoods, Lids (Page 55-8)

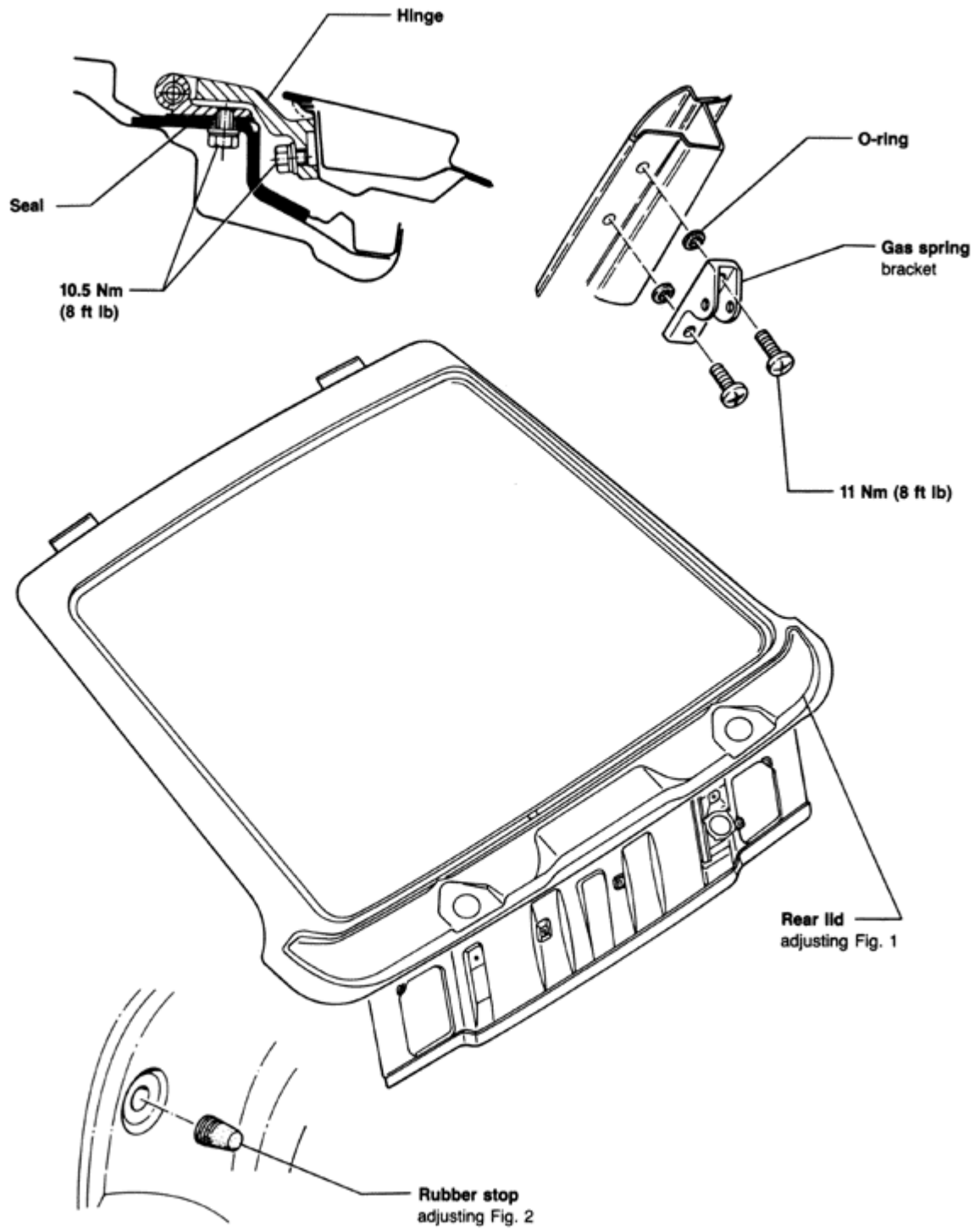

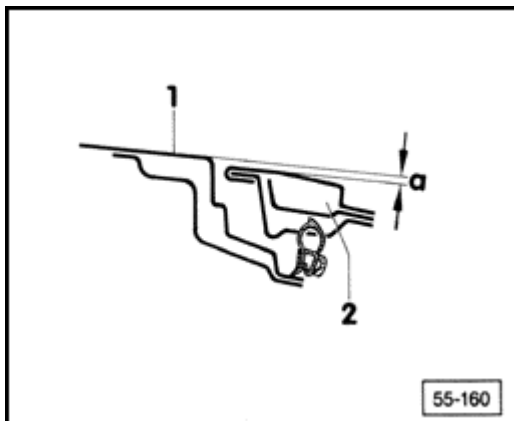

A

Fig. 1 Rear lid, adjusting

- rear lid adjustment is made at hinge (over-size holes)
- adjust lid as shown
 - $a = 1.7 \text{ mm (1/16 in.)}$ (measure at center of roof)
 - 1 - roof contour
 - 2 - lid

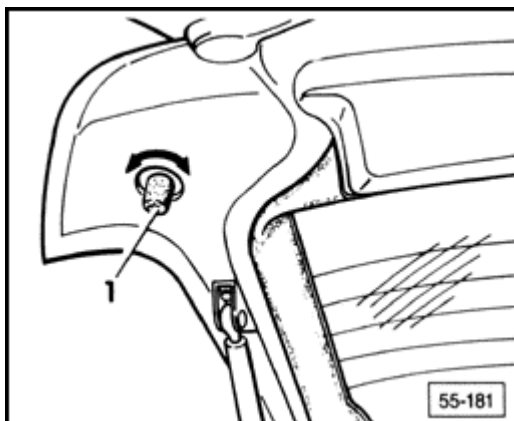

A

Fig. 2 Rubber stop, adjusting

- after adjusting striker, adjust rear lid flush with body by means of rubber stop 1

Volkswagen Corrado 1990 - 1994
 Body
 Hoods, Lids (Page 55-10)

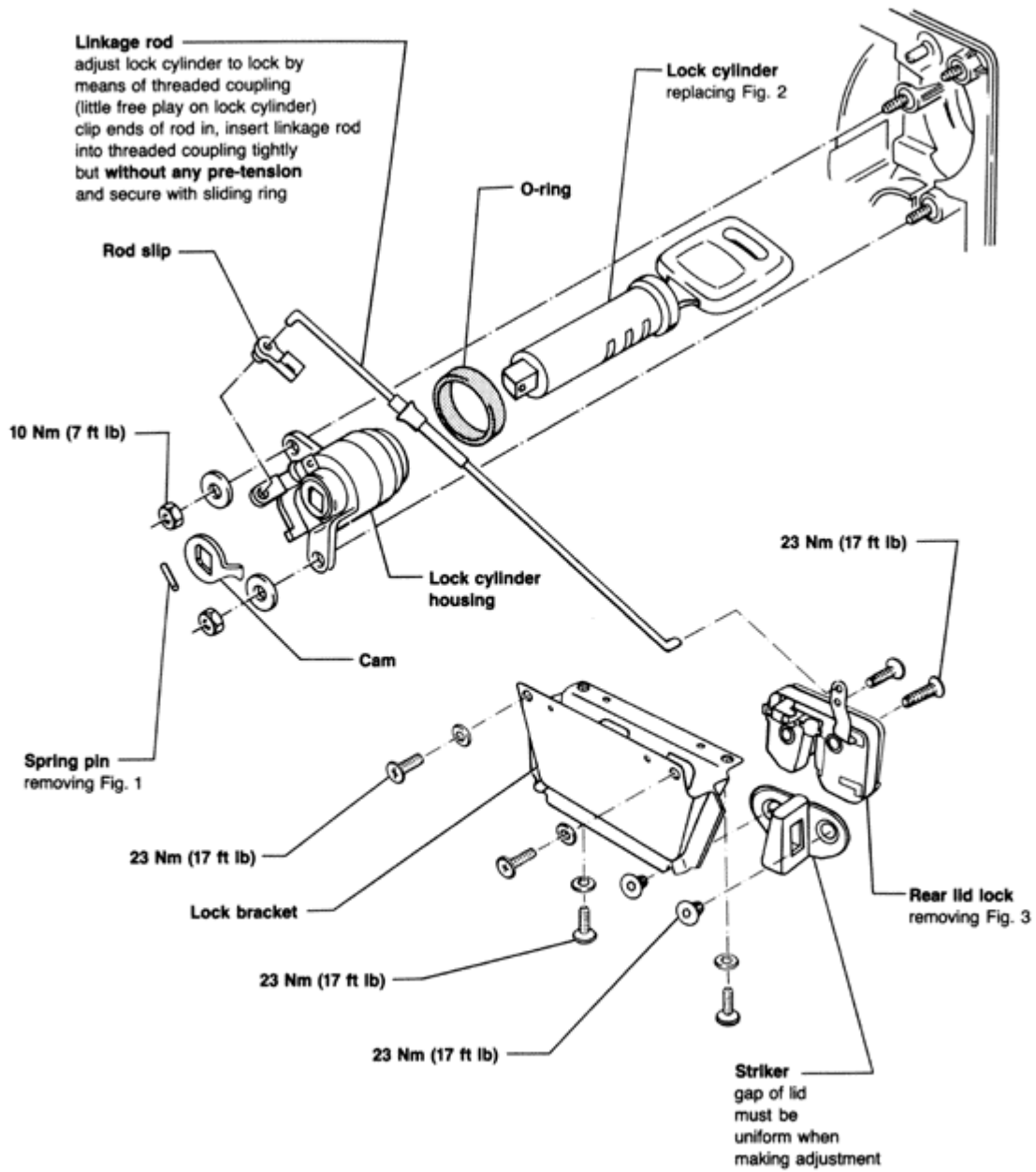

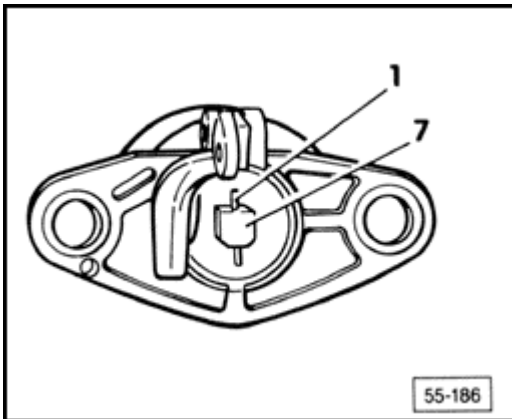

A

Fig. 1 Spring pin, removing

- to remove lock cylinder, spring pin **1** must first be driven out of lock cylinder **7** with a punch

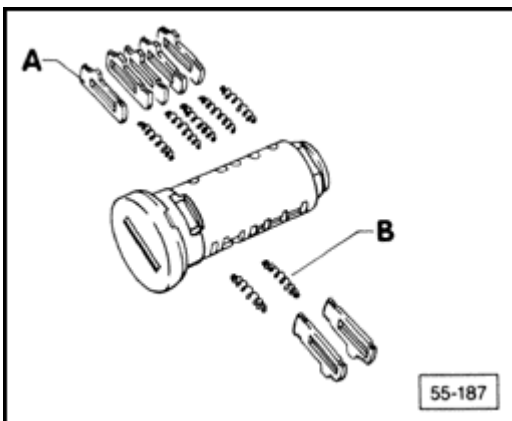

Fig. 2 Lock cylinder, replacing

CAUTION!

Part numbers are for reference only. Always check with your Parts Department for latest information.

- to keep same lock setting of existing locks on vehicle, new lock cylinder must be converted to previous setting by rearranging tumblers
 - for converting of lock setting, tumblers and required springs, check with Parts Department
- lubricate tumblers and springs with grease, Part No. **G 000 400**, before inserting into lock cylinder channels,
- the following tumblers are supplied:
 - Part No. **443 898 041 A** (lock tumbler length 13.5 mm)
 - Part No. **443 898 041** (lock tumbler length 12 mm)
 - **A** - tumblers
 - **B** - tumbler springs

A

Fig. 3 Rear lid lock, repairing

- remove trim and unclip linkage rod
- remove hex head bolt
 - tightening torque = 23 Nm (17 ft lb)
- pull lock out far enough to separate electrical connection (**arrow**) for luggage compartment lighting

Volkswagen Corrado 1990 - 1994
Body
Hoods, Lids (Page 55-12)

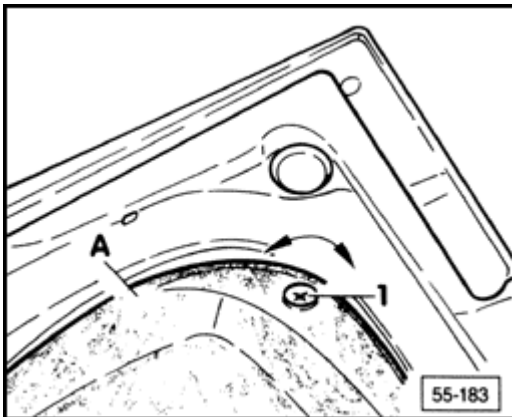

A
Rear lid release, replacing

- rotate twist clip **1** 90° (1/4 turn) (unlock) and remove trim **A**

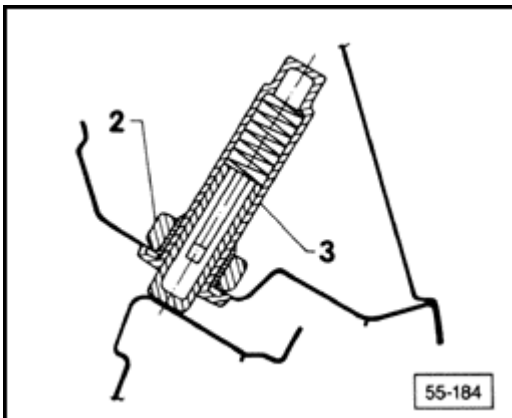

- A**
- unscrew threaded plate **2** and pull opener **3** downward and out from lid

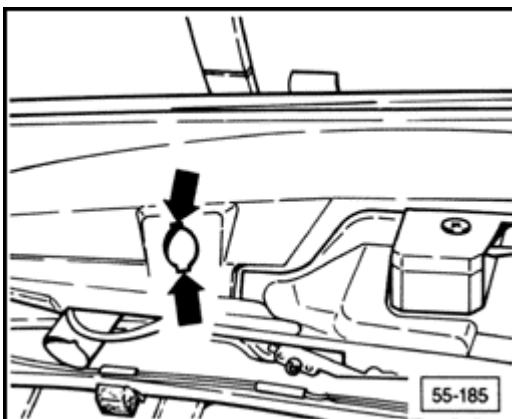

Notes

*When installing, make sure that tab on threaded plate engages cutouts (**arrow**) in lid.*

Volkswagen Corrado 1990 - 1994
Body
Hoods, Lids (Page 55-13)

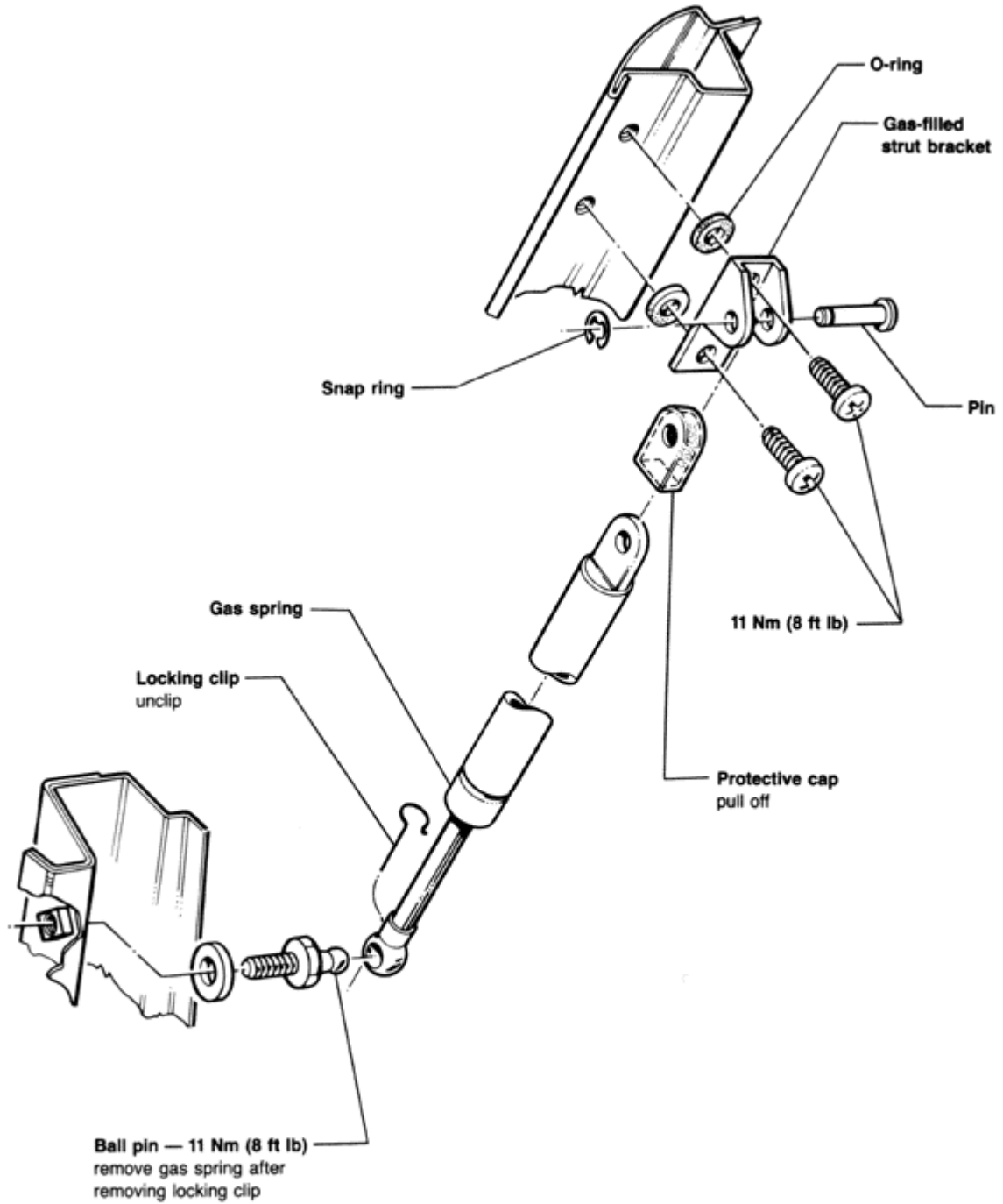

Gas-filled strut, discarding

Notes

After replacing gas-filled strut, gas should be released from unserviceable unit before discarding

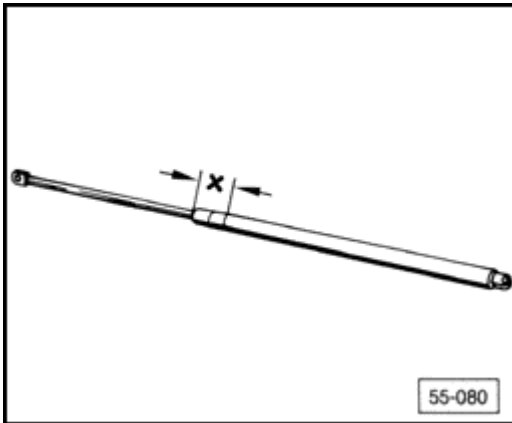

A

- clamp area **X** of strut cylinder in vise
 - area **X** 50 mm (2 in.)
- using hack saw, cut cylinder open immediately to right of vice

CAUTION!

Clamp only in the area marked, otherwise there will be risk of accident! Wear eye protection when sawing.

Notes

Cover the area being sawed with a cleaning cloth to catch any oil that may spray out.

Hood support, replacing

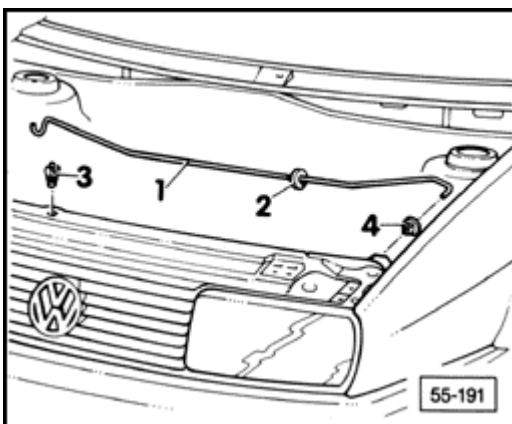

- raise hood support **1** and pull out from bushing **4**
 - 2** - rubber stop
 - 3** - clip for support rod